

THIS COPY IS PROVIDED ON A RESTRICTED BASIS AND IS NOT TO BE USED IN ANY WAY DETRIMENTAL TO THE INTERESTS OF PANDUIT CORP.

PANDUIT P/N	WEIGHT
T70FH4	.77 LB/10 PCS (350 g/10 PCS)

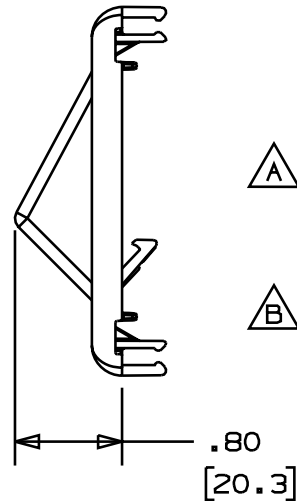
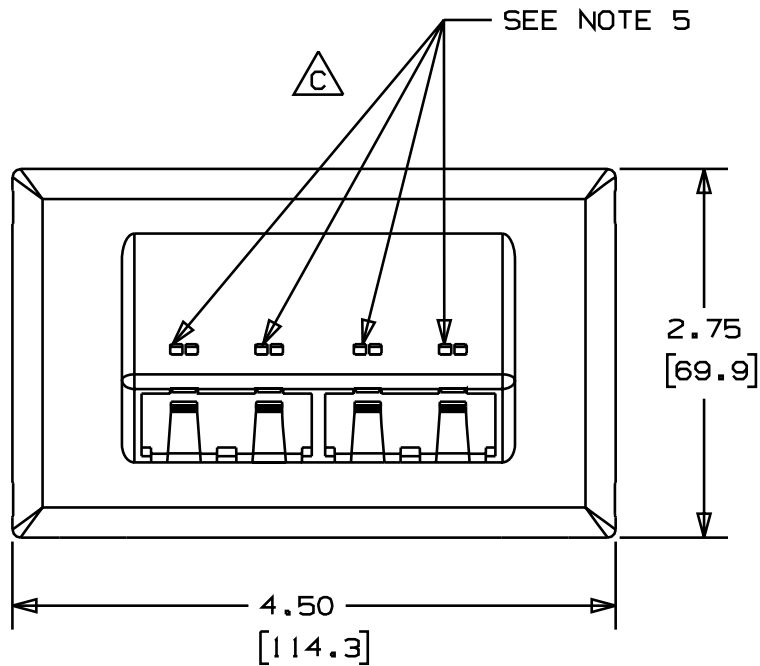

NOTES:

- SEE CURRENT CATALOG FOR ADDITIONAL PART SUFFIXES TO INDICATE COLOR AND OR PACKAGE QUANTITY.
- THE T70FH4 ACCEPTS 4 MINI-COM MODULES.
- DIMENSIONS IN PARENTHESES ARE IN METRIC.
- THE T70FH4 FACEPLATE CAN BE USED WITH PANDUIT SURFACE RACEWAY SYSTEMS AND BOXES THAT ACCEPT 70mm SNAP-ON FACEPLATES (INCLUDES: T-70, TWIN-70, TE70, TG-70, ETC.)
- POCKETS TO BE USED WITH PANDUIT PART NUMBER CIP\*\*\*-C AND CIP\*\*\*-C

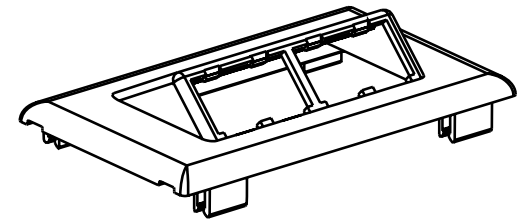

CAD FILENAME/LAYERS D37245BF\_DC\_T70PBH2\_00C

**PANDUIT** CORP. TINLEY PARK, ILLINOIS  
 FOUR MINI-COM MODULE HORIZONTAL  
 SLOPED SNAP-ON FACEPLATE (T70FH4)  
 CUSTOMER DRAWING

UNLESS OTHERWISE SPECIFIED,  
 DIMENSIONAL TOLERANCES ARE:  
 (.X) ± (.XXX) ±  
 (.XX) ± .03 (.8) ANGLES ±

UNLESS OTHERWISE SPECIFIED,  
 ALL DIMENSIONS ARE GIVEN  
 IN INCHES, THIRD ANGLE PROJECTION.

REV	DATE	BY	CHK	DESCRIPTION	ECN	R	CUST	SUP
2	4/18/00	REWE	HIW	C. REVISED GEOMETRY TO INCLUDE ICON POCKETS B. ADDED NOTE 5	37245-07	HIW	HIW	
1	3/2/00	JHNU	HIW	A. ADDED NOTE 4	37245-07	HIW	HIW	
R	9/7/99	DW	CEO	RELEASED TO PRODUCTION.	37245-07	HIW	HIW	

DRAWN BY DW  
 DATE 8/12/99  
 CHK'D HIW

MAT'L: PVC

SCALE NONE  
 DRAWING NO. 37245-07  
 DRG SIZE A